



## Engineering Submittal Form

### CERTIFIED FOR:

Job Name:

Customer Name:

Location:

Customer P.O.:

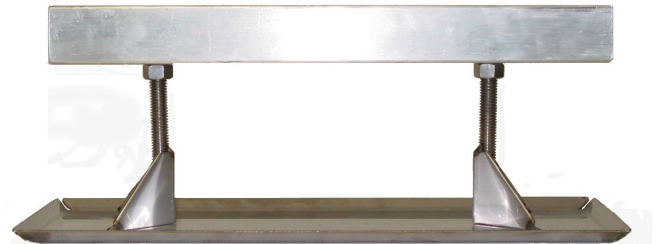
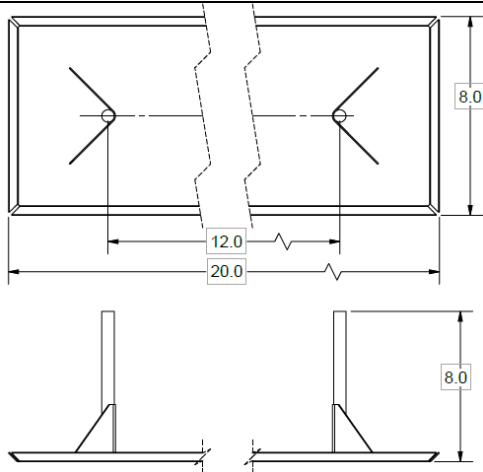

**MX-20SA8**

### Recommended Usage:

Use as a free standing; non-penetrating pipe support stand for all piping applications installed on single ply and built-up roofs within the recommended weight limit. This support is designed to accommodate single or multiple runs of conduit not exceeding weight load of 480lbs.

**MAPA Products Supports are designed and manufactured in accordance with MSS SP-58-2002 and MSS SP-69-2002.**

Refer to MAPA Products "Recommended Installation Guidelines" for standard installation and spacing recommendations.

### Composition:

Strut Assembly	20" – 1 5/8" Aluminum Square Strut
Base	8" X 20" 304 SS
Threaded Rod Assembly	1/2" X 8" 304 SS ATR
Maximum Adjustability	4 1/2" to 8"
Footprint	160 sq in.
Weight Limit	480 lbs
Typical Pipe & Size	Single or Multiple EMT/Rigid Conduit

*\* When used for conduit; specific consideration should be given to the size and number of conduits and the supports recommended weight limit so that maximum support load is not exceeded.*

### Optional Accessories:

- MWP 1224 – 9.2mm thick rubber walk pad.
- Snap-N-Strut Clamps (Refer to SNS selection chart for sizing)

Certification Data							
Support Pad Options							
QTY	NP	P	WP	Pipe Strap	Pipe Size	Service	Notes & Options
	<input type="checkbox"/>	NA	<input type="checkbox"/>	<input type="checkbox"/>			
	<input type="checkbox"/>	NA	<input type="checkbox"/>	<input type="checkbox"/>			

Doc. #: M-13824