



Engineering Submittal Form

CERTIFIED FOR:

Job Name:

Customer Name:

Location:

Customer P.O.:

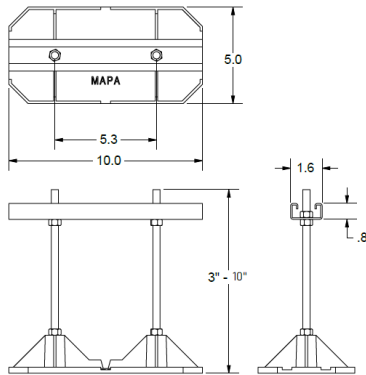

MS-10SA10

Recommended Usage:

Use as a free standing; non-penetrating pipe support stand for multiple piping systems installed on single ply and built-up roofs. For 2" or Smaller Condensates / Single or Multiple EMT/Rigid Conduit with weight loads not exceeding 150lbs.

MAPA Products Supports are designed and manufactured in accordance with MSS SP-58-2002 and MSS SP-69-2002.

Refer to MAPA Products "Recommended Installation Guidelines" for standard installation and spacing recommendations.

Composition:

Strut Assembly	10" – 1 5/8" Aluminum Shallow Strut
Base	UV Protected Nylon 5" X 10"
Rod Assembly	304 SS ATR
Maximum Adjustability	3" to 10"
Footprint	50 sq in.
Weight Limit	150 lbs
Typical Pipe & Size	2" or Smaller Condensates / Single or Multiple EMT/Rigid Conduit
Suffix "P"	Integrated 1/8" Isolation Pad

Optional Accessories:

- MWP 914 – 9.2mm thick rubber walk pad.
- Snap-N-Strut Clamps (Refer to SNS selection chart for sizing)

Certification Data

Support Pad Options							
QTY	NP	P	WP	Pipe Strap	Pipe Size	Service	Notes & Options
	<input type="checkbox"/>	<input type="checkbox"/>	<input type="checkbox"/>	<input type="checkbox"/>			
	<input type="checkbox"/>	<input type="checkbox"/>	<input type="checkbox"/>	<input type="checkbox"/>			

Doc. #: M-13805