



Engineering Submittal Form

CERTIFIED FOR:

Job Name:

Customer Name:

Location:

Customer P.O.:

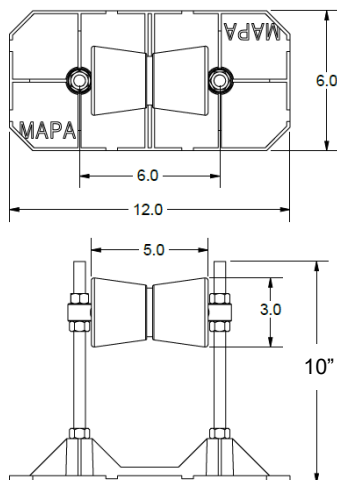

MS-5RA10

Recommended Usage:

Use as a free standing, non-penetrating adjustable low-profile, light to medium duty pipe support for piping installed on single ply or built-up roofs. For 5" IPS Pipe Size with weight load not to exceed 165lbs.

MAPA Products Supports are designed and manufactured in accordance with MSS SP-58-2002 and MSS SP-69-2002.

Refer to MAPA Products "Recommended Installation Guidelines" for standard installation and spacing recommendations.

Composition:

| | |
|-----------------------|--|
| Roller Assembly | 304 SS Collars & Shaft / SS ATR / UV Protected SBR Rubber Roller |
| Base | UV Protected Nylon 6" X 12" |
| Rod Assembly | 304 SS ATR |
| Maximum Adjustability | 3" to 10" |
| Footprint | 72 sq in. |
| Weight Limit | 216 lbs |
| Typical Pipe & Size | Single 5" Sch. 40 or smaller Natural Gas |
| Suffix "P" | Integrated 1/8" Isolation Pad |

Optional Accessories:

- MWP 1016 – 9.2mm thick rubber walk pad.
- MPS-17 - 1" X 14" -Stainless steel pipe strap.

Certification Data

| Support Pad Options | | | | | | | |
|---------------------|--------------------------|--------------------------|--------------------------|--------------------------|-----------|---------|-----------------|
| QTY | NP | P | WP | Pipe Strap | Pipe Size | Service | Notes & Options |
| | <input type="checkbox"/> | <input type="checkbox"/> | <input type="checkbox"/> | <input type="checkbox"/> | | | |
| | <input type="checkbox"/> | <input type="checkbox"/> | <input type="checkbox"/> | <input type="checkbox"/> | | | |

Doc. #: M-13610